

# GREAT MAGTECH

ELECTRIC CO.,LTD

格锐特磁（厦门）电气有限公司



Tel: 86-0592-6682467 Fax: 86-592-6682467

Email: pcmagnet@greatmagtech.com

Web: www.greatmagtech.com

# MAGNETIC CHUCK

# CONTENTS

P02  
-  
P07



Electromagnetic permanent magnet sucker

P08



Rectangular all steel permanent magnet chuck

P09



Supported single-dip all-steel permanent magnet chuck

P10



Locking type single-tilt all-steel permanent magnet sucker

P11



Double-dip all-steel permanent magnet chuck

P11

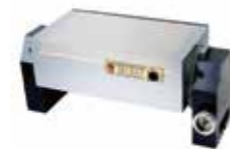

Tilting (slewing) permanent magnet chuck

P12



Round permanent magnet chuck

P13



Special suction cup for EDM machine



## COMPANY PROFILE

In addition to high performance permanent magnets, GME is the leading global supplier of magnets and magnetic solutions for industrial, research and engineering applications, and strives to be the Great service leading provider worldwide.

Founded in 2000, GME was formed to advance development of magnet technology as an OEM wholesale supplier of permanent magnets and magnetic products. By interacting closely with its customers and focusing on a market-driven product line, GME has positioned itself to readily meet the challenges of today's dynamic global economy.

The company's magnetic disks are: X41-plane, X42 single tilt, X43 double tilt, X45 swing, X51 round and other series specifications. The product uses high-performance iron reinforced magnetic material as the magnetic source, and has the characteristics of strong suction, magnetic uniformity, less residual magnetism, high efficiency, long service life, convenient operation, safety and reliability, and advanced structure. It is the best new tool for machining centers, surface grinders, wire cutters, EDM machines and scribing or other positioning and reinforcement.

# ELECTRIC PERMANENT MAGNET SUCKER



延伸块: 50×50×30/75×75×20mm  
Pole extension: 50×50×30/75×75×20mm

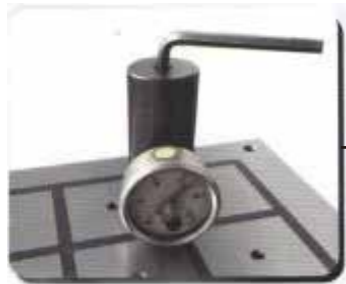

最大吸力可达17kgf/cm<sup>2</sup>  
The max clamping force can be 17kgf/cm<sup>2</sup>

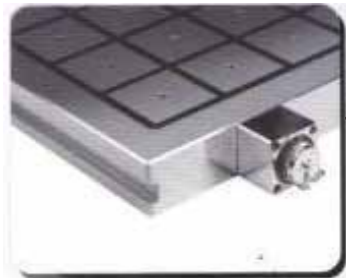

光滑的倒角  
Smooth chamfer



侧面抛光  
Side polishing

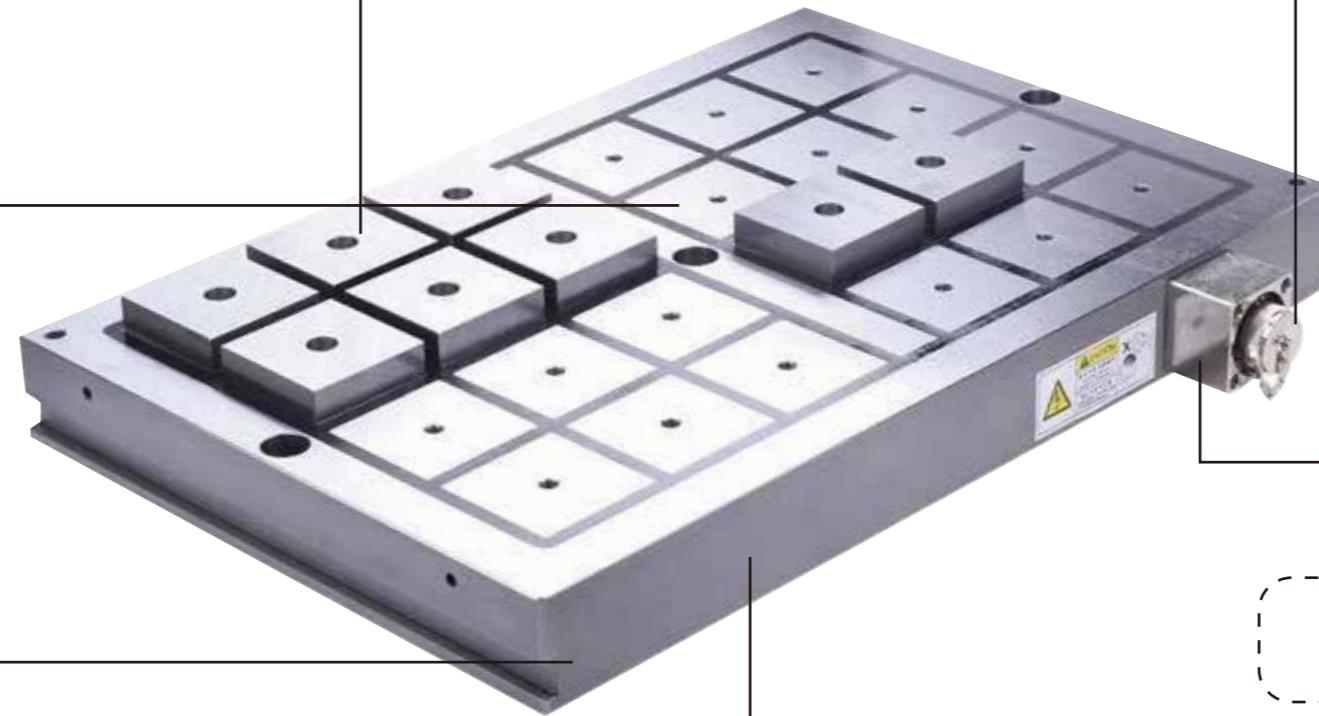

高防水快速接头  
Waterproof quick connectors



引流孔  
Drainage hole

防撞接线盒  
Anticollision connecting box

不锈钢线缆  
Steel cable

控制器 Control unit



控制器面板  
Control unit faceplate

遥控器  
Remote controller

吸盘连接  
Chuck connection port

CNC控制输入点  
CNC control port

电源连接  
Power connection port

遥控器接口  
Remote controller connection port

## GME-EP 50 SERIES

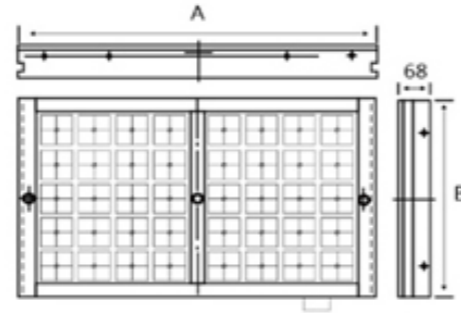

### Product introduction

#### Description

1. Comprising 50mm\*50mm poles with a force of 15-17kgf/cm<sup>2</sup>.
2. It is possible to predetermine the force generated by counting the number of poles, work piece gripping at least 4 pole contact faces.
3. Controller do the Magnetizing or demagnetizing in 0.5 ~ 5 seconds.
4. Chuck is tested for Slipping force, Waterproof test, Temperature rise test, Electrical & Demagnetizing tests

#### Use

1. Used for normal and heavy duty drilling, milling, and CNC machining center for normal and heavy duty drilling, milling, and CNC machining center
2. Best used for the workpieces at least 250\*250 mm and 10 mm thick. used for small, medium dimensions with normal operating air gaps and thinner workpieces.

#### Standard Features and Benefits

1. Flexibility:
  - Allow single set-up machining with 5-sided accessibility
  - workpieces larger than the table are machinable
2. Safety
  - No electric power supply during clamping.
  - Constant and uniform magnetic power over entire area.
  - No temperature rise in operation. so no impact on precision and work piece deformation due to temperature rise. Can used for long time.

## Specifications

Model型号	Dimension(mm)			Poles number	Weight(kgs)	
	Length	Width	High		Net	Gross
GMEEP50-205	470	258	68	18	64	72
GMEEP50-206	595	258	68	24	81	89
GMEEP50-208	775	258	68	30	106	116
GMEEP50-209	900	258	68	36	123	133
GMEEP50-210	1025	258	68	42	140	152
GMEEP50-303	327	315	68	16	54	62
GMEEP50-304	436	315	68	24	78	86
GMEEP50-305	496	315	68	28	85	93
GMEEP50-306	595	315	68	32	99	109
GMEEP50-308	775	315	68	40	129	139
GMEEP50-309	900	315	68	48	150	162
GMEEP50-310	1025	315	68	56	171	183
GMEEP50-403	430	320	68	24	73	82
GMEEP50-405	490	430	68	36	112	120
GMEEP50-406	605	436	68	48	140	150
GMEEP50-408	775	436	68	60	179	189
GMEEP50-409	900	436	68	72	208	220
GMEEP50-410	1000	400	68	84	212	225
GMEEP50-503	500	315	68	28	83	92
GMEEP50-505	510	500	68	42	135	142
GMEEP50-506	605	500	68	56	160	170
GMEEP50-508	770	500	68	70	204	214
GMEEP50-509	900	500	68	84	238	250
GMEEP50-510	1010	500	68	98	267	278
GMEEP50-603	600	310	68	32	98	106
GMEEP50-604	600	436	68	48	140	150
GMEEP50-605	600	500	68	56	139	149
GMEEP50-606	615	600	68	72	195	207
GMEEP50-608	625	770	68	90	255	267
GMEEP50-609	890	615	68	108	290	320
GMEEP50-610	1010	615	68	126	329	349

# GME-EP 75 SERIES

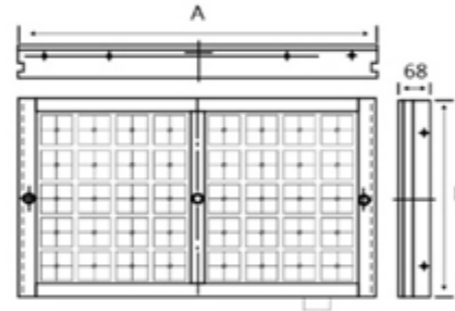

## Product introduction

### Description

1. Comprising 75mm\*75mm poles with a force of 15-17kgf/cm<sup>2</sup>.
2. It is possible to predetermine the force generated by counting the number of poles, work piece gripping at least 4 pole contact faces.
3. Controller do the Magnetizing or demagnetizing in 0.5 ~ 5 seconds.
4. Chuck is tested for Slipping force, Waterproof test, Temperature rise test, Electrical & Demagnetizing tests

### Use

1. Used for normal and heavy duty drilling, milling, and CNC machining center
2. Best used for the workpieces at least 400\*400 mm and 18 mm thick, Ideal for general pieces of various dimensions with normal operating air gaps and medium thicknesses

### Standard Features and Benefits

1. Flexibility:
  - Allow single set-up machining with 5-sided accessibility
  - workpieces larger than the table are machinable
2. Safety
  - No electric power supply during clamping
  - Constant and uniform magnetic power over entire area.
  - No temperature rise in operation. so no impact on precision and work piece deformation due to temperature rise. Can used for long time.

### 3. Eicient

- Easy and quick position, reduce set-up time and increase available machine time.
- High accuracies and tolerances

### 4. Cost-effectiveness

- no maintenance
- no machine modifications· reduced tool consumption

### Specifications

Model	Dimension(mm)			Poles number	Weight(kgs)	
	Length	Width	High		Net	Gross
GMEEP75-206	620	230	68	12	75	83
GMEEP75-208	770	230	68	16	93	102
GMEEP75-210	1030	230	68	20	126	136
GMEEP75-304	410	320	68	12	69	77
GMEEP75-305	510	340	68	15	80	86
GMEEP75-306	620	300	68	18	98	108
GMEEP75-308	770	300	68	24	123	133
GMEEP75-310	1030	300	68	30	164	176
GMEEP75-404	420	420	68	16	93	101
GMEEP75-405	510	420	68	20	113	121
GMEEP75406	630	420	68	24	140	148
GMEEP75-408	810	420	68	32	180	188
GMEEP75410	1030	420	68	40	229	239
GMEEP75-502	510	230	68	10	62	69
GMEEP75-604	510	420	68	20	113	121
GMEEP75-506	630	500	68	30	167	175
GMEEP75-608	810	600	68	40	215	223
GMEEP75-509	950	510	68	45	256	272
GMEEP75-510	1000	500	68	50	265	275
GMEEP75-602	610	230	68	12	74	84
GMEEP75-604	630	420	68	24	140	148
GMEEP75-606	600	600	68	36	190	200
GMEEP75-608	800	600	68	48	255	262
GMEEP75-610	1020	600	68	60	324	336

## RECTANGULAR ALL-STEEL PERMANENT-MAGNETIC CHUCK

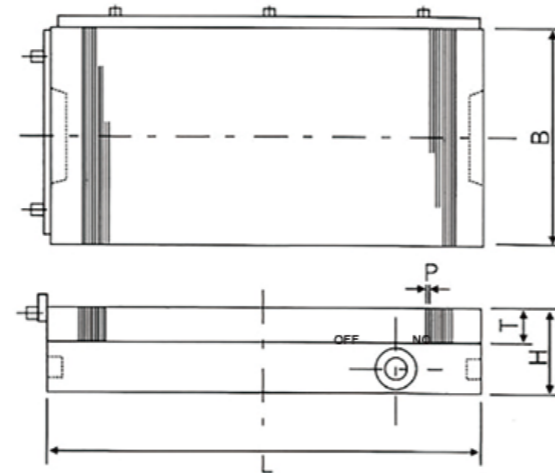

### Product introduction

#### Use

1. Suitable for grinding.
2. Best for larger workpiece.

#### Feature

1. Permanent magnetic chuck with Neodymium magnets, strong magnetic force and less remaining magnetism
2. ON-OFF control by means of hand lever. In the OFF position, a weak opposing field eases the removal of the workpiece
3. Parallel fine pole pitch: 6 mm (4mm of steel + 2mm of brass)
4. Nominal holding force: 100N/cm<sup>2</sup>. Pole plate wearing limit: 5mm
6. Magnetic field height: 6mm
7. Coolant and water proof structure
8. Parallelism, flatness and squareness 0.005mm/100mm

### Specifications

Model	B	L	H	t	Suction	P	Weight( Kg)
GME41 -1010	100	100	45	18	12Kg or 10Kg or 8Kg	2 ( 0.5+1.5 ) or 4 ( 1+3 ) 3 or 1.5 ( 0.5+1 )	3.6
GME41 -7016	70	160	45	18			4
GME41 -1515	150	150	48	20			8
GME41 -1520		200	48				11
GME41 -1525		250	48				13.8
GME41 -1530		300	48				16.8
GME41 -1535		350	48				19.6
GME41 -1540		400	53				23.8
GME41 -1545		450	53				26.5
GME41 -2020	200	200	48	22			15
GME41 -2D25		250	48				18.5
GME41 -2D35		350	53				28.5
GME41 -2040		400	53				31.8
GME41 -2045		450	53				39.5
GME41 -2550	250	500	58	23			53.5
GME41 -3060	300	600	58	23	77		

## SUPPORTED SINGLE-DIP ALL-STEEL PERMANENT MAGNET CHUCK

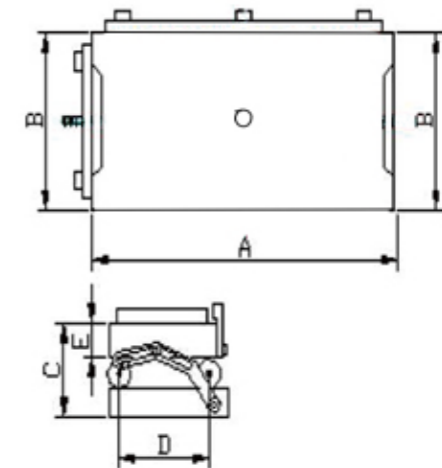

### Product introduction

Smaller workpieces can be used with this machine, and the accuracy is within 0.005mm.

## Specifications

Model	L	E	C	D	E	A	P	Tilt	weight(Kg)
GME42-10175A	175	100	90	75	48	205	2(0.5+1.5)	0-45°	10
GME42-1515A	150	150		100		13.3			
GME42-1530A	300	150		100		30			
GME42-12525A	250	125		75		17.9	4(1+3)		

## LOCKING TYPE SINGLE-TILT ALL-STEEL PERMANENT MAGNET SUCKER

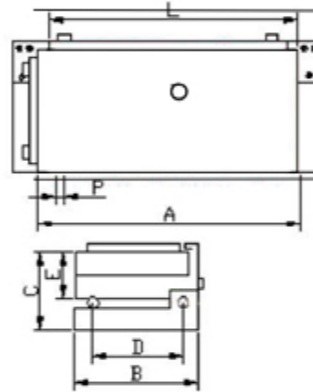

## Product introduction

### Use

Suit for high grinding EDM for Angle process.

### Feature

quality steel and processed by heat treatment. The parallel degree 0.005mm/100mm of angles with high hardness and precision is obtained by the agauge block.

## Specifications

Model	L	B	C	D	E	A	F	Tilt	weight(Kg)
GME42- 10175	175	100	86	75	48	225	2(0.5+1.5)	0-60°	11.5
GME42- 1515	150	150		100		15			
GME42- 1530	300	150		100		32			
GME42- 12525	250	125		75		19.5	4(1+3)		

## DOUBLE-DIP ALL-STEEL PERMANENT MAGNET CHUCK

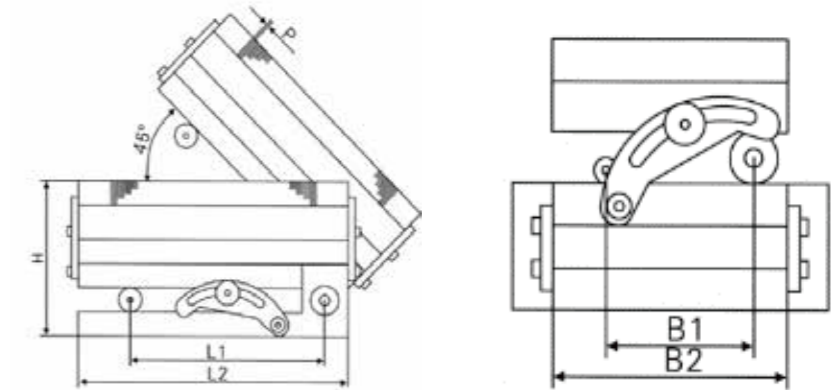

## Product introduction

### Use

Suit for high-precision angle grinding processing at the front and back or left and right angles.

### Feature

The base is made of high-quality steel and processed by heat treatment. The parallel degree 0.005mm/100mm of angles with high hardness and precision is obtained by the agauge block.

## Specifications

Model	L1	L2	L3	H	B1	B2	F	Oblique anhle	Weight(Kg)
GME43-10175A	100	205	175	120	75	100	2 (0.5+1.5) or 4 (1+3)	0-45°	12
GME43-1515A	100	130	150	125	100	150			16
GME43-1530A	150	330	300	125	100	150		32.5	
GME43-10175	100	225	175	110	15	100		0-60°	12.6
GME43-1515	100	200	150	115	100	150			17
GME43-1530	150	350	300	115	100	150			34.5

## TILTING (SLEWING) PERMANENT MAGNET CHUCK

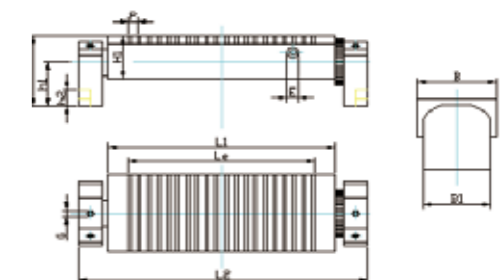

## Product introduction

Suitable for angle grinding of grinding machines. Features: A scale is attached to the rotating spindle. Easy to grind at various angles. The body is integrally formed on the rotating main shaft. The plane accuracy does not change when ON/OFF is switched.

### Specifications

Model	B	LI	HI	H2	L2	P	Weight(Kg)
GME45- 125X250	125	250	95	145	350	2( 0. 5+1. 5) or 4(1+3)	28.5
GME45- 125X300	150	300	105	160	400		39. 5
GME45- 125X350	150	350	105	160	450		45.5
GME45- 125X450	150	450	105	160	550		56. 1

## ROUND PERMANENT MAGNET CHUCK

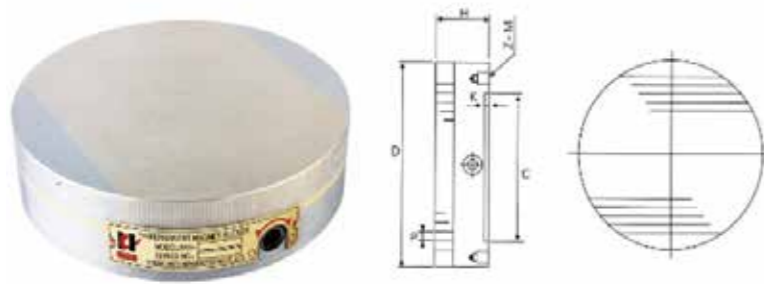

## Product introduction

The circular permanent magnet chucks can be divided into ordinary type, straight strip type and auxiliary shot type according to their structures.

### Specifications

Model	D	H	K	C	Z		P	weight(Kg)
GME51- 125	125	48	3	80	4	M6	2(0. 5+1. 5) or 4(1+3)	4.6
GME51- 150	150	48	3	100	4	M6		6.6
GME51- 175	175	48	3	100	4	M8		8.9
GME51- 200	200	52	4	120	4	M8		12.8
GME51- 250	250	52	4	160	4	M8		20
GME51- 500	300	58	4	220	4	M8		32
GME51- 320	320	58	4	248	4	M10		36. 5
GME51- 400	400	58	4	300	4	M10		57
GME51- 500	500	65	5	408	4	M12		100
GME51- 600	600	65	5	528	4	M12		144

## SPECIAL SUCTION CUP FOR EDM MACHINE

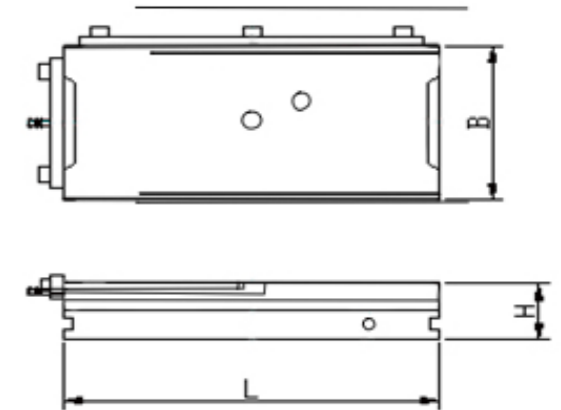

## Product introduction

The special suction cup for EDM machine has the oil-cleaning oil hole decontamination fast, no adhesion, the suction clamp workpiece is firm, the precision is high, and the loading and unloading processing is fast. It is the most ideal EDM machine clamping equipment.

### Specifications

Model	Size			Suction	Magnetic Pole	Net Weight
	L	B	H			
GMEDH41-1530	300	150	48	8kg/cm2	2(0.5+1.5) or 4(1+3)	16.8
GMEDH41-1535	350	150	48			19.6
GMEDH41-1540	400	150	52			23.8
GMEDH41-2040	400	200	52			31.8